

RECORD OF OWNERSHIP

DICKENSON COUNTY PUBLIC
SERVICE AUTHORITY
HAYSI VA

24256

DATE RECORDED *6-5-85*
DEED OR WILL BOOK *DB 0228 0121*
CONSIDERATION *2 tracts 150,000*

CLASS *7*
ZONING
DISTRICT *07*

LEGAL DESCRIPTION
HAYSI
1AC

Year	Value of Land	Value of Improvements	Total Value	Assessment
1992				
1993				
1994	<i>5,000</i>	<i>500,000</i>	<i>505,000</i>	
1995	<i>5,000</i>	<i>500,000</i>	<i>505,000</i>	
1996				
1997				
1998	<i>5,000</i>	<i>500,000</i>	<i>505,000</i>	
1999				
2000				
2001				
2002				
2003				

BUILDING PERMITS

NO.	TYPE	DATE	% COMP.	DATE FINAL	APPROVAL	APPROVAL

NOTES:

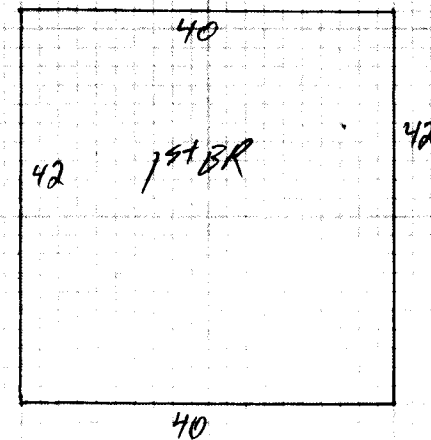

Sewer Plant

Dwelling	Comp. Sh.	Wood Siding	Yr. Built <u>95</u> Remod.	Bsmt. [] 2nd []	Plaster	BATH(S) Full <input type="checkbox"/> 1/2 Bath(s) <input type="checkbox"/>
<input checked="" type="checkbox"/>	Slate	Brick	No. Stories	1st [/] 3rd []	Sheet rock	Modern Bath <input type="checkbox"/> Modern Kitchen <input type="checkbox"/>
	Asbestos	Asb. Wood Shg.	S. Level <input type="checkbox"/> S. Foyer <input type="checkbox"/>	Total No. Bedrooms	Ceiled	Cent. Heat <input type="checkbox"/> A/C <input type="checkbox"/>
	Metal	Cin. Block <input type="checkbox"/> Stone <input type="checkbox"/>			Panel	Fir. or Wall Furnace <input type="checkbox"/> Stove(s) <input type="checkbox"/>
Wood Frame	Tar & Grav.	Stucco <input type="checkbox"/> Con. Block <input type="checkbox"/>	Crawl <input type="checkbox"/> Conc. <input type="checkbox"/>	HW <input type="checkbox"/> Pine <input type="checkbox"/> Carp. <input type="checkbox"/> Tile <input type="checkbox"/>	Unfinished	<input checked="" type="checkbox"/>
Cin. Block	Tile	Aluminum <input type="checkbox"/> Masonite <input type="checkbox"/>	Riers <input type="checkbox"/> Cin. Bik. <input type="checkbox"/>			Number <u>10</u>
Steel Frame	Shakes	Storm Doors <input type="checkbox"/> Storm Win. <input type="checkbox"/>	Slab <input type="checkbox"/> Brick <input type="checkbox"/>	Disappearing Stairs	Gd. <input type="checkbox"/> Fair <input type="checkbox"/> Poor <input type="checkbox"/> VP <input type="checkbox"/>	Number Chimneys
			Basement Size <u>10</u>	Attic Floor & Stairs	Brick [] C. Block []	

Gd. <input type="checkbox"/> Fair <input type="checkbox"/> Poor <input type="checkbox"/> VP <input type="checkbox"/>	Basmt. Finish	1/4 <input type="checkbox"/> 1/2 <input type="checkbox"/> 3/4 <input type="checkbox"/> Full <input type="checkbox"/>	Attic <input type="checkbox"/> Walls <input type="checkbox"/> Fl. <input type="checkbox"/>	Stone [] Metal []
--	---------------	--	--	---------------------

TYPE	SIZE	RATE	VALUE	RENT	REMARKS	YR.	MARKET VALUE
Dwelling							
Porch					<p>APPROX COST INCLUDES: TRUNKS, PIPES, SHED, BLDG & FENCE</p>		
Porch							
Carport							
Garage							
Cent. A/C							
Basement							

M & L	M & L	MURDER HOME INFORMATION	Market Value All Improvements	<u>500,000</u>
DATE	DATE	Owner	Market Value All Land	<u>5,000</u>
APRP <u>MC</u>	APRP.	Make Year	TOTAL MARKET VALUE	<u>505,000</u>
DATE <u>3/11/94</u>	DATE	Size Cond.	USE VALUE OF IMPROVEMENTS RECAP	
CLASSIFICATION	ZONING	Not Home <input type="checkbox"/> Time	Average	Use Value
		AM <input type="checkbox"/> PM <input type="checkbox"/>	Agric.	
			Hort.	
			Forest	
			Open Space	
			Totals	

POINTS ON			LAND VALUE COMPUTATIONS					LAND VALUE COMPUTATIONS					Sale Price	
Frontage	Depth	Square Footage	Unit Price	Depth Factor	Front Ft. Rate	TOTAL	ADJ.	1990 TOTAL APPRAISAL	Unit Price	Depth Factor	Front Ft. Rate	TOTAL		ADJ.

PROPERTY FACTORS		CLASSIFICATION	ACRES	RATE	ADJ.	CLASSIFICATION	ACRES	RATE	ADJ.
Public Water	<input checked="" type="checkbox"/> Paved	Home Site	<u>1</u>			Home Site		<u>5000</u>	
Public Sewer	<input checked="" type="checkbox"/> Gravel								
Well	<input type="checkbox"/> Dirt								
Spring	<input type="checkbox"/> No Road								
Septic System	<input type="checkbox"/> Curb & Gutter	Wasteland				Wasteland			
U. G. Utilities	<input type="checkbox"/> Sidewalk	Total Acreage	<u>1</u>	Total Value Land	<u>5000</u>	Total Acreage		Total Value Land	

ELEVATION TOPOGRAPHY			General Remarks:
LEVEL <input type="checkbox"/>	SLOPES UP <input type="checkbox"/>	SLOPES DOWN <input type="checkbox"/>	<i>Information from Ron Phillips</i>
LOW <input type="checkbox"/>	STEEP UP <input type="checkbox"/>	STEEP DOWN <input type="checkbox"/>	

BOARD REVIEW NOTES