

BAKER R E  
BOX 340  
CLINTWOOD VA

24228

DATE RECORDED *6-76*  
DEED OR WILL BOOK *DB 0177 0457*  
CONSIDERATION *100*

CLASS *1*  
ZONING  
DISTRICT *06*

LEGAL DESCRIPTION  
HOLLY CREEK  
.25 AC

|      |               |               |                |
|------|---------------|---------------|----------------|
| 1992 |               |               |                |
| 1993 |               |               |                |
| 1994 | <i>35,000</i> | <i>65,000</i> | <i>100,000</i> |
| 1995 | <i>35,000</i> | <i>65,000</i> | <i>100,000</i> |
| 1996 |               |               |                |
| 1997 |               |               |                |
| 1998 | <i>35,000</i> | <i>65,000</i> | <i>100,000</i> |
| 1999 |               |               |                |
| 2000 |               |               |                |
| 2001 |               |               |                |
| 2002 |               |               |                |
| 2003 |               |               |                |

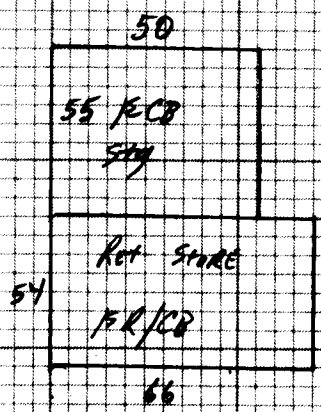

NOTES:

*Clintwood Lumber & Supply*

|              |             |                |                    |                      |                     |                 |                     |
|--------------|-------------|----------------|--------------------|----------------------|---------------------|-----------------|---------------------|
| Dwelling     | Comp. Sh.   | Wood Siding    | Yr. Built          | Remod.               | Bemt.               | Plaster         | BATH(S)             |
| STORE ✓      | State ✓     | Brick ✓        | 40                 | 1                    | 1st [4] 3rd [ ]     | Sheet rock      | Full 1/2 Bath(s)    |
|              | Asbestos    | Asb. Wood Shg. | No. Stories        | S. Level             | S. Foyer            | Ceciled         | Modern Bath         |
|              | Metal       | Cin. Block     | Total No. Bedrooms |                      |                     | Panel           | Modern Kitchen      |
| Wood Frame   | Tar & Grav. | Stucco         | Crawl              | Conc.                | HW                  | Unfinished      | Cent. Heat          |
| Cin. Block ✓ | Tile        | Aluminum       | Flers              | Cin. Blk.            |                     |                 | A/C                 |
| Steel Frame  | Shakes      | Storm Doors    | Slab               | Brick                | Disappearing Stairs |                 | Fr. or Wall Furnace |
|              |             |                | Basement Size      | Attic Floor & Stairs |                     |                 | Stoves              |
|              |             |                | Gd. Fair Poor VP   | Basmt. Finish        | 1/4 1/2 3/4 Full    | Attic Walls Fl. | Stone Metal         |

BRICB 3564 18 64,152  
 CB 2750 10 27,500

|                    |        |     |        |
|--------------------|--------|-----|--------|
| Dwelling           | 91,652 | 40% | 55,000 |
| Misc. Bldg & Sheds |        | FV  | 10,000 |
| Porch              |        |     |        |
| Carport            |        |     |        |
| Garage             |        |     |        |
| Cent. A/C          |        |     |        |

|               |                |        |                               |         |
|---------------|----------------|--------|-------------------------------|---------|
| Basement      | M & L          | M & L  | Market Value All Improvements | 65,000  |
| Basmt. Finish | DATE           | DATE   | Market Value All Land         | 35,000  |
| Attic         | APRP.          | APRP.  | Owner                         | 100,000 |
| Fireplace(s)  | DATE           | DATE   | Make                          |         |
| Heating       | APRP.          | APRP.  | Size                          |         |
| Bath(s)       | DATE           | DATE   | Not Home                      |         |
| Total         | 3-7-94         |        | Time                          |         |
| Factor        | CLASSIFICATION | ZONING | AM                            | PM      |
| Replacement   | 4              |        |                               |         |

|     |     |        |            |  |
|-----|-----|--------|------------|--|
| 100 | 350 | 35,000 | Land Cost  |  |
|     |     |        | \$         |  |
|     |     |        | Bldg. Cost |  |
|     |     |        | \$         |  |
|     |     |        | Sale Price |  |
|     |     |        | \$         |  |
|     |     |        | Rent       |  |
|     |     |        | \$         |  |
|     |     |        | Expenses   |  |
|     |     |        | \$         |  |
|     |     |        | Net Rent   |  |
|     |     |        | \$         |  |

| CLASSIFICATION | ACRES | RATE | ADJ. | CLASSIFICATION | ACRES | RATE   | ADJ. |
|----------------|-------|------|------|----------------|-------|--------|------|
| Home Site      | .25   |      |      | Home Site      |       |        |      |
| Comm.          |       |      |      |                |       |        |      |
| Wasteland      |       |      |      | Wasteland      |       |        |      |
|                | .25   |      |      |                |       | 35,000 |      |

General Remarks:

LEVEL  SLOPES UP  SLOPES DOWN

LOW  STEEP UP  STEEP DOWN

BOARD REVIEW NOTES