

WILLIS BERTHA & J S RT 2 BOX 134 ABINGDON VA 24210	DATE RECORDED	10-01-93
	DEED OR WILL BOOK	DB 113-284
	CONSIDERATION	

CLASS	2	LEGAL DESCRIPTION GEORGES FORK 4.5 AC 7.27 AC
ZONING		
DISTRICT	01	

Willis Johnny P.O. Box 72 Clintwood, Va. 24228	DATE RECORDED	1-31-94
	DEED OR WILL BOOK	298-32
	CONSIDERATION	Gift

1992			
1993			
1994	800		800
1995	800		800
1996	2500		2500
1997			
1998	2500		2500
1999	5200	20,200	25400
2000			
2001			
2002			
2003			

H & D Enterprise P.O. Box 2040 Clintwood, Va 24228	DATE RECORDED	4-15-99
	DEED OR WILL BOOK	344-601
	CONSIDERATION	2 tracts 39,000

	DATE RECORDED	
	DEED OR WILL BOOK	
	CONSIDERATION	

	DATE RECORDED	
	DEED OR WILL BOOK	
	CONSIDERATION	

NOTES: VALUE OF MINERALS
 Bertha + J.S. Willis Reserve life Estate

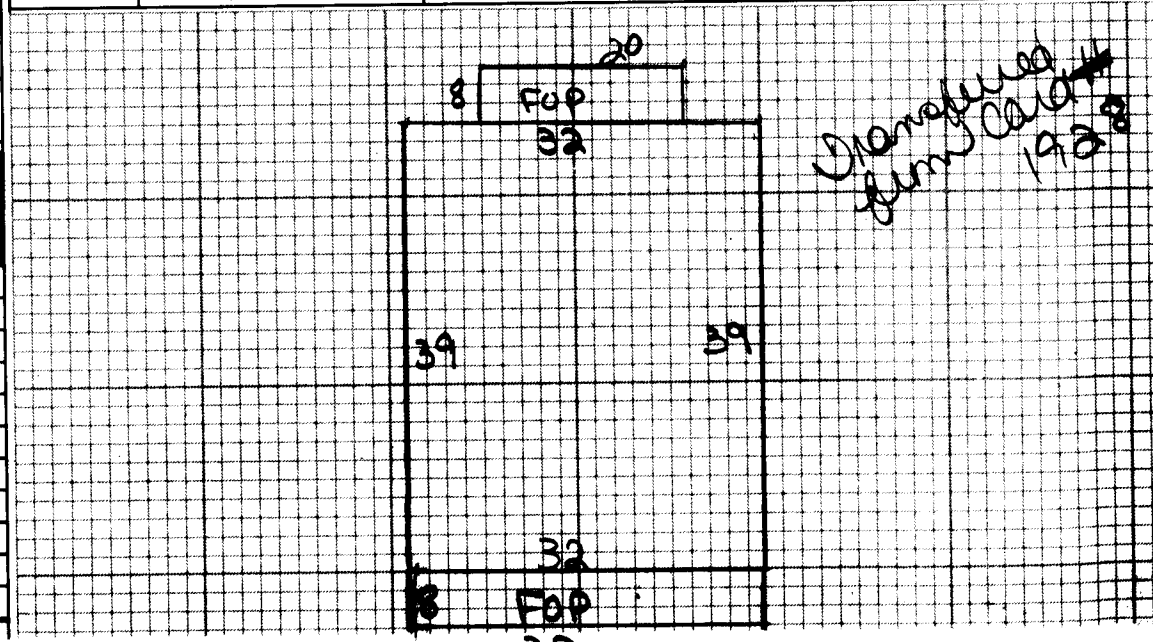

Dwelling	<input checked="" type="checkbox"/>	Comp. Sh.	<input checked="" type="checkbox"/>	Wood Siding		Yr. Built	<u>40</u>	Remod.		Bsmt.	[]	2nd	<input checked="" type="checkbox"/>	Plaster		BATH(S)	Full	1/2 Bath(s)			
		State		Brick	<input checked="" type="checkbox"/>	No. Stories	<u>1 1/2</u>	1st	<input checked="" type="checkbox"/>	3rd	[]	Sheet rock	<input checked="" type="checkbox"/>	Modern Bath	<input type="checkbox"/>	Modern Kitchen	<input type="checkbox"/>				
		Asbestos		Asb. Wood Shg.		S. Level	<input type="checkbox"/>	S. Foyer	<input type="checkbox"/>	Total No. Bedrooms	<u>8</u>	Ceciled		Cont. Heat	<u>OIL</u>	A/C					
		Metal		Cin. Block	<input type="checkbox"/>	Stone	<input type="checkbox"/>	Crawl	<input type="checkbox"/>	Conc.	<input type="checkbox"/>	HW	<input type="checkbox"/>	Pine	<input type="checkbox"/>	Carp.	<input type="checkbox"/>	Tile	<input checked="" type="checkbox"/>		
Wood Frame	<input checked="" type="checkbox"/>	Tar & Grav.		Stucco	<input type="checkbox"/>	Con. Block	<input type="checkbox"/>	Flrs	<input type="checkbox"/>	Cin. Blk.	<input checked="" type="checkbox"/>	Unfinished									
Cin. Block		Tile		Aluminum	<input type="checkbox"/>	Masonite	<input type="checkbox"/>	Slab	<input type="checkbox"/>	Brick	<input type="checkbox"/>	Disappearing Stairs		Gd.	<input type="checkbox"/>	Fair	<input type="checkbox"/>	Poor	<input type="checkbox"/>	VP	<input type="checkbox"/>
Steel Frame		Shales		Storm Doors	<input type="checkbox"/>	Storm Win.	<input type="checkbox"/>	Basement Size	<u>100%</u>	Attic Floor & Stairs		Attic	<input checked="" type="checkbox"/>	Walls	<input checked="" type="checkbox"/>	Fl.	<input checked="" type="checkbox"/>	Number	<u>NO</u>		

<u>1 1/2 BR</u>	<u>1872</u>	<u>285</u>	<u>53352</u>																		

Dwelling						<u>D-</u>		<u>50497</u>		<u>60%</u>		<u>20200</u>									
Porch	<u>0</u>	<u>256</u>	<u>6</u>	<u>1536</u>																	
Porch	<u>E</u>	<u>160</u>	<u>6</u>	<u>960</u>																	
Carport																					
Garage																					
Cent. A/C																					
Basement	<u>1248</u>	<u>4</u>	<u>4992</u>																		

Market Value All Improvements	<u>20200</u>
Market Value All Land	<u>800-2500-5200</u>
	<u>800-2540-25400</u>
Owner	
Make	Year
Size	Cond.
Not Home	<input type="checkbox"/>
Time	
AM	<input type="checkbox"/>
PM	<input type="checkbox"/>

DATE	<u>1-10-94</u>
CLASSIFICATION	<u>2</u>
ZONING	
Total	<u>60840</u>
Factor	<u>.83</u>
Replacement	<u>50497</u>

Agric.		Land Cost	
Hort.		\$	
Forest		Bldg. Cost	
Open Space		\$	
Totals		Sale Price	
		\$	
		Rent	
		\$	
		Expenses	
		\$	
		Net Rent	
		\$	

CLASSIFICATION	ACRES	RATE	ADJ.	CLASSIFICATION	ACRES	RATE	ADJ.
Home Site	<u>1.54</u>		<u>350</u>	Home Site			
	<u>7.54</u>	<u>500</u>	<u>800</u>				
	<u>5.73</u>	<u>300</u>	<u>1719</u>				
Wasteland			<u>5200</u>	Wasteland			
	<u>1.54</u>		<u>800-2519</u>				

General Remarks: Deeds Attached
Deegee changed per Brenda Kilgus, she disowned this
doing so title search on property, couldn't find where any
had been sold. 2/5/11/94

LEVEL SLOPES UP SLOPES DOWN
 LOW STEEP UP STEEP DOWN

BOARD REVIEW NOTES

#251
#708

BOOK 298 PAGE 032

THIS DEED OF GIFT, made this 1st day of October, 1993, by and between J. W. WILLIS and BERTHA MAE WILLIS, husband and wife, GRANTORS, and JOHNNY WILLIS, GRANTEE.

WITNESSETH:

THAT for and in consideration of love and affection for their son, the Grantors do hereby give, grant and convey unto the Grantee, all those two (2) certain parcels of land situate in Dickenson County, Virginia, and more particularly described as follows, to-wit:

PARCEL 1

All that certain parcel of land situate on the right hand side of Georges Fork Creek in Dickenson County, Virginia, containing 3.07 acres, more or less, and described as follows:

BEGINNING at a point in the Georges Fork highway and in the outside line of the original tract, being a common corner between Part No. 3 and Part No. 4; thence, with lines of Part No. 3 on the left, N 58° 53' W 391.2 feet to a stake on a hillside; thence, N 43° 30' W 241.1 feet to a stake on a hillside; thence, N 36° 53' W 396.0 feet to a stake on a hillside; thence, S 76° 35' W 124.0 feet to a stake on a hillside and in a line of the curtesy portion of Part No. 4; thence, with a part of a line of the same, N 39° 30' W 102.4 feet to a stake on the south side of the top of the ridge and in the outside line of said tract; thence, with the outside line, N 76° 35' E 262.0 feet to a large fallen chestnut oak on the ridge (white oak witness) (black oak and persimmon trees called); thence, down a spur, S 35° 00' E 380.2 feet to a 16 inch black oak on a cliff; thence, S 43° E 241.1 feet to a 14 inch black oak on a steep part of the spur; thence, S 58° 52' E 391.2 feet to a point in the east side of the Georges Fork highway;

#251
#708

thence, S 17° 42' W 122.7 feet to the point of BEGINNING, and containing 3.07 acres, more or less.

Source of Title: And being identically the same real estate conveyed to Kemper Willis (J. S.) by deed dated August 12, 1959, from G. Mark French, Special Commissioner, which is of record in the Office of the Clerk of the Circuit Court of Dickenson County, Virginia, in Deed Book No. 130, at page 462, reference to which is hereby made.

PARCEL 2

All that certain parcel of land situate on the waters of George's Fork of Pound River in the Clintwood Magisterial District of Dickenson County, Virginia, containing 7.27 acres, more or less, and described as follows:

BEGINNING at a point in the George's Fork highway and in the outside line of the original tract, being a common corner between Part No. 1 and Part No. 2; thence, with lines of Part No. 2 on the left, N 52° 33' W 615.0 feet to a stake under the brink of a flat; thence, S 24° 34' W 120.0 feet to a large forked black oak on a flat spur (maple witness); an original corner in the outside line of the tract; thence, with the outside line, N 31° 25' W 248.2 feet to a 16 inch black oak on the spur; thence, N 25° 45' W 487.5 feet to an 8 inch white oak and a 4 inch sourwood on a spur; thence, leaving the outside line and with the Arizona Fleming courtesy portion, N 77° 43' E 239.2 feet to a stake on the east side of a path in a hollow, a corner to Part No. 3; thence, with lines of Part No. 3 down the hollow, S 33° 25' E 320.0 feet to a 14 inch black walnut in the east side of the hollow; thence, S 50° 21' E 299.2 feet to a stake on a hillside; thence, S 58° 17' E 180.4 feet to a stake in a path on the hillside east of the Moore home; thence, S 73° 11' E 111.7 feet to a point in the east side