

TICKLE JAMES & GOLDIE
 C/O ALLEN TICKLE
 RT 3 BOX 128
 CLINTWOOD VA 24228

DATE RECORDED
 DEED OR WILL BOOK 124 - 201
 CONSIDERATION

CLASS 2
 ZONING
 DISTRICT 01

LEGAL DESCRIPTION
 HOLLY CREEK
 10.51AC

1992	10800	49900	60700
1993	10800	49900	60700
1994			
1995			
1996			
1997			
1998			
1999			
2000			
2001			
2002			
2003			

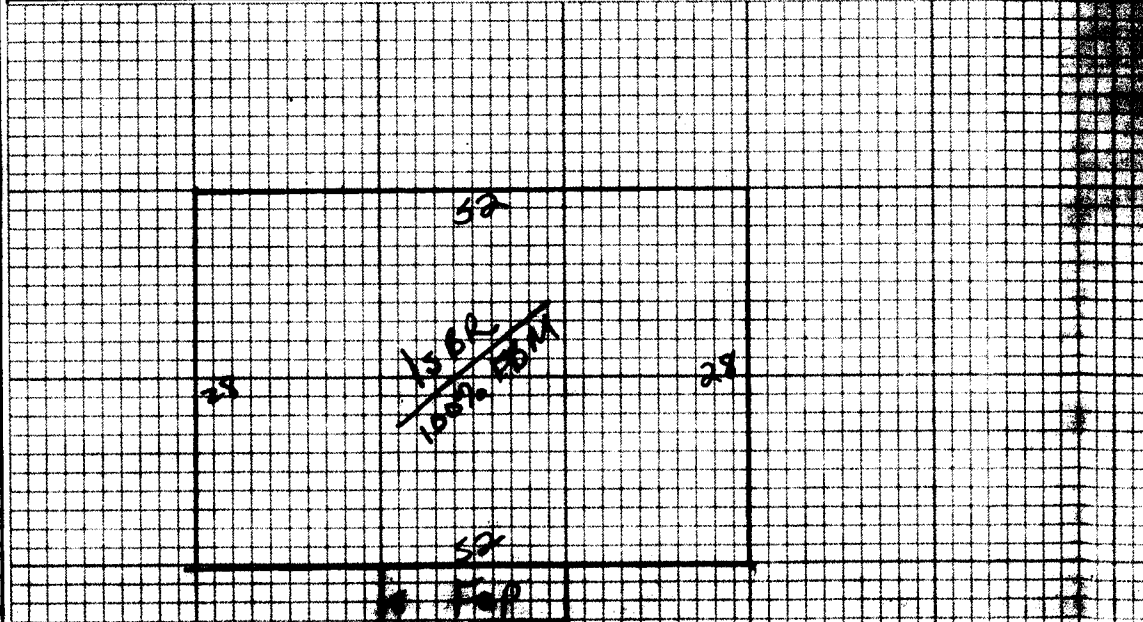

NOTES:

Dwelling	Comp. Sh.	Wood Siding	Yr. Built	Plowed	Barr.	Plaster	BATHS
Stone	Brick	Brick	No. Stories	1st	2nd	Sheet rock	Full
Asbestos	Ash. Wood Shg.	Ash. Wood Shg.	S. Land	S. Floor	Total No. Bathrooms	Ceiled	Modern Bath
Metal	Cin. Block	Cin. Block	Ceiling	Conc.	HW	Plin	Modern Kitchen
Wood Frame	Tar & Grav.	Stucco	Alum.	Masonite	Flors	Cin. Sh.	Cont. Heat
Cin. Block	Tile	Aluminum	Masonite	Flors	Cin. Sh.	Unfinished	Pr. or Wall Furnace
Steel Frame	Shingles	Storm Doors	Storm Win.	Stab	Brick	Disappearing Stairs	Number
							Number Chimneys
							Brick
							C. Block
							Stone
							Metal

BR 1456 33 48047

136 10 1360

1456 1 1456

1456 65 9464

2000

Total 62328

Factor 1.0

Replacement 62328

62328 20% 49900

M & L

DATE

APPR.

DATE 5-9-91

CLASSIFICATION

ZONING

Market Value All Improvements 49900

Market Value All Land 10800

60700

Land Cost

Bldg. Cost

Sale Price

Rent

Expenses

Net Rent

Public Water	Paved	Public Sewer	Gravel	Well	Dirt	Spring	No Road	Septic System	Curb & Gutter	U. S. Utilities	Sidewalk

General Remarks: 710 finished basement.

LOW

STEEP UP

STEEP DOWN

BOARD REVIEW NOTES