

<del>ROSE HOBERT GERALD &amp; NANCY</del> <del>RT 2 BOX 121</del> <del>CLINTWOOD VA</del>  24228	DATE RECORDED	4-27-81
	DEED OR WILL BOOK	DE 207-474
	CONSIDERATION	

Rose, Eddie Et AL Rt 2 Box 121 Clintwood, Va 24228	DATE RECORDED	
	DEED OR WILL BOOK	27-359
	CONSIDERATION	

	DATE RECORDED	
	DEED OR WILL BOOK	
	CONSIDERATION	

	DATE RECORDED	
	DEED OR WILL BOOK	
	CONSIDERATION	

	DATE RECORDED	
	DEED OR WILL BOOK	
	CONSIDERATION	

BUILDING PERMITS					
NO.	TYPE	DATE	APPLICANT	STATUS	REMARKS

NOTES:	VALUE OF MINERALS

CLASS	2	LEGAL DESCRIPTION HONEY CAMP BRANCH 0.605 A
ZONING		
DISTRICT	01	

1992				
1993				
1994	3,500	24,300	27,800	
1995	3,500	24,300	27,800	
1996				
1997				
1998	3,500	24,300	27,800	
1999				
2000				
2001				
2002				
2003				

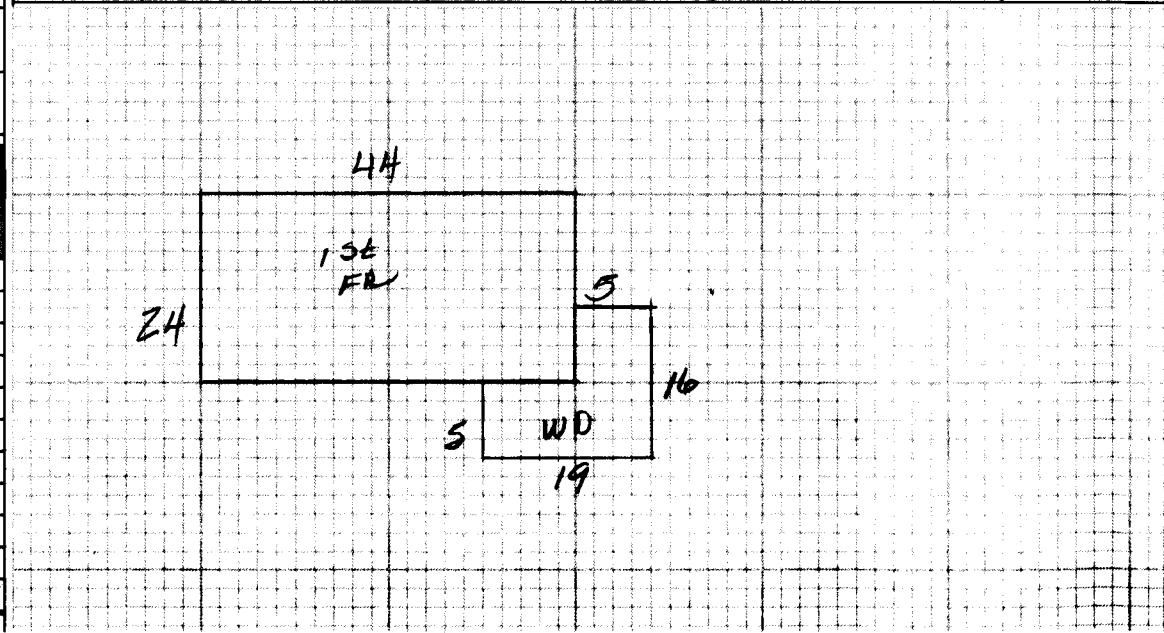

Dwelling	<input checked="" type="checkbox"/> Comp. Sh.	<input checked="" type="checkbox"/> Wood Siding	Yr. Built <b>80</b>	Remod.	Bsmt. <input type="checkbox"/> 2nd <input type="checkbox"/>	Plaster	BATHS) / Full / 1/2 Bath(s)
	Slate	Brick	No. Stories	<b>1</b>	1st <b>5</b> 3rd <input type="checkbox"/>	Sheet rock	Modern Bath <input type="checkbox"/> Modern Kitchen <input type="checkbox"/>
	Asbestos	Asb. Wood Shg.	S. Level <input type="checkbox"/> S. Foyer <input type="checkbox"/>		Total No. Bedrooms	Ceciled	Cent. Heat <input checked="" type="checkbox"/> A/C
	Metal	Cin. Block <input type="checkbox"/> Stone <input type="checkbox"/>				Panel	Fir. or Wall Furnace <input type="checkbox"/> Stove(s) <input type="checkbox"/>
Wood Frame	<input checked="" type="checkbox"/> Tar & Grav.	Stucco <input type="checkbox"/> Con. Block <input type="checkbox"/>	Crawl <input type="checkbox"/> Conc. <input type="checkbox"/>		HW <input type="checkbox"/> Pine <input type="checkbox"/> Carp. <input type="checkbox"/> Tile <input checked="" type="checkbox"/>	Unfinished	
Cin. Block	Tile	Aluminum <input checked="" type="checkbox"/> Masonite <input type="checkbox"/>	Flers <input type="checkbox"/> Cin. Blk. <input type="checkbox"/>				Number
Steel Frame	Shakes	Storm Doors <input type="checkbox"/> Storm Win. <input type="checkbox"/>	Slab <input type="checkbox"/> Brick <input type="checkbox"/>		Disappearing Stairs	Gd. <input type="checkbox"/> Fair <input checked="" type="checkbox"/> Poor <input type="checkbox"/> VP <input type="checkbox"/>	Number Chimneys
			Basement Size		Attic Floor & Stairs		Brick <input type="checkbox"/> C. Block <input type="checkbox"/>

1st 1056 28 29 568

Gd.  Fair  Poor  VP  Bsmt. Finish  Attic  Walls  Fl.  Stone  Metal  YR. **94**

Dwelling **D** 26,637 10% 24,000

Stg Bld

FV 300

Porch 150 7 1050

Porch  
Carport  
Garage  
Cent. A/C

Basement  
Bsmt. Finish  
Attic  
Fireplace(s)  
Heating  
Bath(s)  
Total **30,618**  
Factor **87**  
Replacement **26,637**

M & L  
DATE  
APRP. **MC**  
DATE **1-7-94**  
CLASSIFICATION **Z**

MOBILE HOME INFORMATION  
Owner  
Make Year  
Size Cond.  
Not Home  Time  
AM  PM

Market Value All Improvements **24,300**  
Market Value All Land **3,500**  
**TOTAL MARKET VALUE 27,800**

Land Cost  
Bldg. Cost  
Sale Price  
Rent  
Expenses  
Net Rent

FRONTION				SIDE WALL				REAR WALL				TOTAL			
Width		Depth		Width		Depth		Width		Depth		Width		Depth	

PROPERTY FACTORS	CLASSIFICATION	ACRES	RATE	ADJ.	CLASSIFICATION	ACRES	RATE	ADJ.
Public Water Public Sewer Well Spring Septic System U. G. Utilities	Home Site	.605			Home Site			
	Wasteland				Wasteland			
		.605					3500	

General Remarks:  
LEVEL  SLOPES UP  SLOPES DOWN   
LOW  STEEP UP  STEEP DOWN

BOARD REVIEW NOTES