

POWERS ROGER  
 24228 BOX 813  
 CLINTWOOD VA

24228

DATE RECORDED 5-78  
 DEED OR WILL BOOK 191-578  
 CONSIDERATION

CLASS 2  
 ZONING  
 DISTRICT 01

LEGAL DESCRIPTION  
 GEORGES FORK  
 1.71AC

	DATE RECORDED	
	DEED OR WILL BOOK	
	CONSIDERATION	
	DATE RECORDED	
	DEED OR WILL BOOK	
	CONSIDERATION	
	DATE RECORDED	
	DEED OR WILL BOOK	
	CONSIDERATION	
	DATE RECORDED	
	DEED OR WILL BOOK	
	CONSIDERATION	

1992	4500	15800	20300
1993	4500	15800	20300
1994			
1995			
1996			
1997			
1998			
1999			
2000			
2001			
2002			
2003			

NOTES:

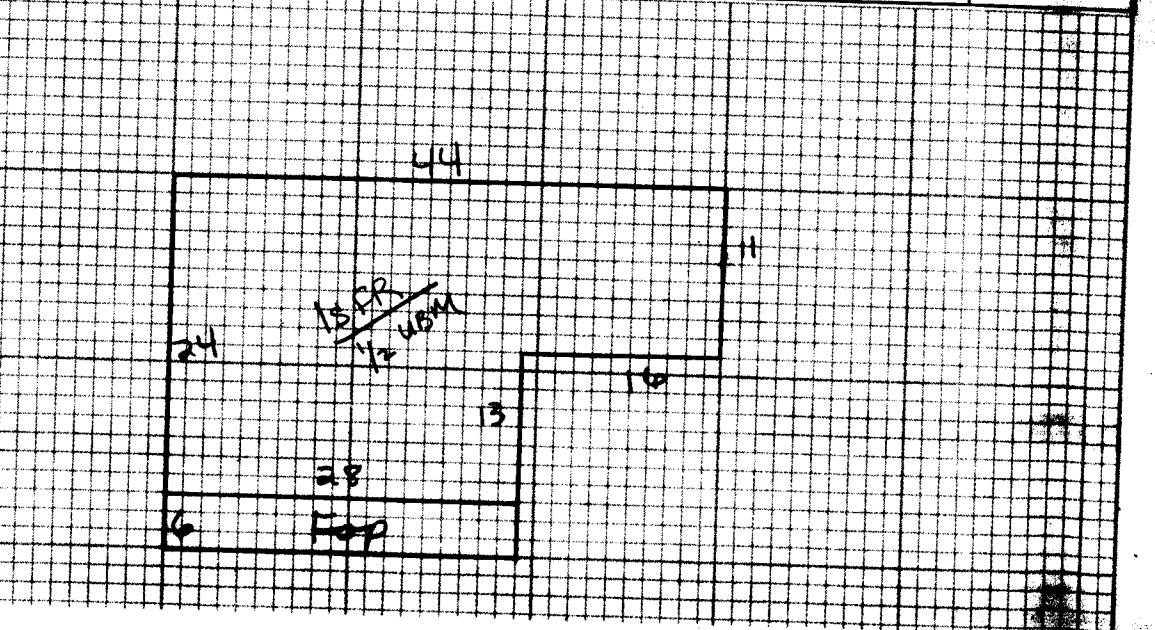

Dwelling	<input checked="" type="checkbox"/>	Comp. Sh.		Wood-Strng	Comp	<input checked="" type="checkbox"/>	Yr. Built	45	Remod.		Bmnt.	<input type="checkbox"/>	2nd	<input type="checkbox"/>	Plaster		BATHS	Full	<input type="checkbox"/>	1/2 Bath	<input type="checkbox"/>		
		State		Brick			No. Stories				1st	<input checked="" type="checkbox"/>	3rd	<input type="checkbox"/>	Sheet rock	<input checked="" type="checkbox"/>	Modern Bath	<input type="checkbox"/>	Modern Kitchen	<input type="checkbox"/>			
		Asbestos		Asb. Wood Shg.			S. Level	<input type="checkbox"/>	S. Poyer	<input type="checkbox"/>	Total No. Bedrooms				Ceolled		Cent. Heat	Coal					
		Metal	<input checked="" type="checkbox"/>	Cin. Block	<input type="checkbox"/>	Stone	<input type="checkbox"/>								Panel	<input checked="" type="checkbox"/>	Fl. or Wall Furnace	<input type="checkbox"/>	Stove	<input type="checkbox"/>			
Wood Frame	<input checked="" type="checkbox"/>	Tar & Grav.		Stucco	<input type="checkbox"/>	Con. Block	<input type="checkbox"/>	Crawl	<input type="checkbox"/>	Conc.	<input type="checkbox"/>	NW	<input type="checkbox"/>	Flne	<input type="checkbox"/>	Corp.	<input checked="" type="checkbox"/>	Tile	<input type="checkbox"/>	Unfinished			
Cin. Block		Tile		Aluminum	<input type="checkbox"/>	Masonry	<input type="checkbox"/>	Flors	<input type="checkbox"/>	Cin. Blk.	<input checked="" type="checkbox"/>										Number	70	
Steel Frame		Shakes		Storm Doors	<input type="checkbox"/>	Storm Win.	<input type="checkbox"/>	Slab	<input type="checkbox"/>	Brick	<input type="checkbox"/>	Disappearing Stairs			Ed.	<input type="checkbox"/>	Feir	<input type="checkbox"/>	Feer	<input type="checkbox"/>	VP	<input type="checkbox"/>	
				Basement Size		1/2		Attic Floor & Stairs														Number Chimneys	
				Basmt. Finish				1/4	<input type="checkbox"/>	1/4	<input type="checkbox"/>	1/4	<input type="checkbox"/>	Full	<input type="checkbox"/>	Attic	<input type="checkbox"/>	Walls	<input type="checkbox"/>	Fl.	<input type="checkbox"/>	Brick	<input type="checkbox"/>
																						Stone	<input type="checkbox"/>
																						Metal	<input type="checkbox"/>

13 FR 848 33 27984 yr. 1997 yr. yr.

Dwelling				D		27913	452	15400															
				CAR SHED	24x24																		
Porch	0	168	8	1344																			
Porch																							
Carport																							
Garage																							
Cent. AC																							

Basement	424	6.5	2756	M & L		M & L		Market Value All Improvements	15800
Basmt. Finish				DATE		DATE		Market Value All Land	4500
Attic				APRP	AB	APRP.			20300
Fireplaces				DATE	6-11-91	DATE			
Heating				CLASSIFICATION		ZONING			
Baths									
Total	32084								
Factor	.87								
Replacement	27913								

Land Cost									
Bldg. Cost									
Sale Price									
Rent									
Expenses									
Net Rent									
Public Water	Paved	<input checked="" type="checkbox"/>							
Public Sewer	Gravel								
Well	<input checked="" type="checkbox"/> Dirt								
Spring	No Road								
Septic System	<input checked="" type="checkbox"/> Curb & Gutter								
U. S. Utilities	Sidewalk								
			1.71				4500		

General Remarks:

LOW  SLOPES UP  STEEP UP  STEEP DOWN

BOARD REVIEW NOTES