

ERVINTON DISTRICT

0000000001276

MULLINS SHELDON WINFORD & JOYCE RT 1 BOX 375 CLINTWOOD VA 24228	DATE RECORDED	7-70
	DEED OR WILL BOOK	DB 0146 0080
	CONSIDERATION	3000
	DATE RECORDED	
	DEED OR WILL BOOK	
	CONSIDERATION	
	DATE RECORDED	
	DEED OR WILL BOOK	
	CONSIDERATION	
	DATE RECORDED	
	DEED OR WILL BOOK	
	CONSIDERATION	
	DATE RECORDED	
	DEED OR WILL BOOK	
	CONSIDERATION	

CLASS	2	LEGAL DESCRIPTION BIG RIDGE 3AC		
ZONING				
DISTRICT	02			
1992				
1993				
1994		4,200	38,400	42,600
1995		4,200	38,400	42,600
1996				
1997				
1998				
1999				
2000				
2001				
2002				
2003				

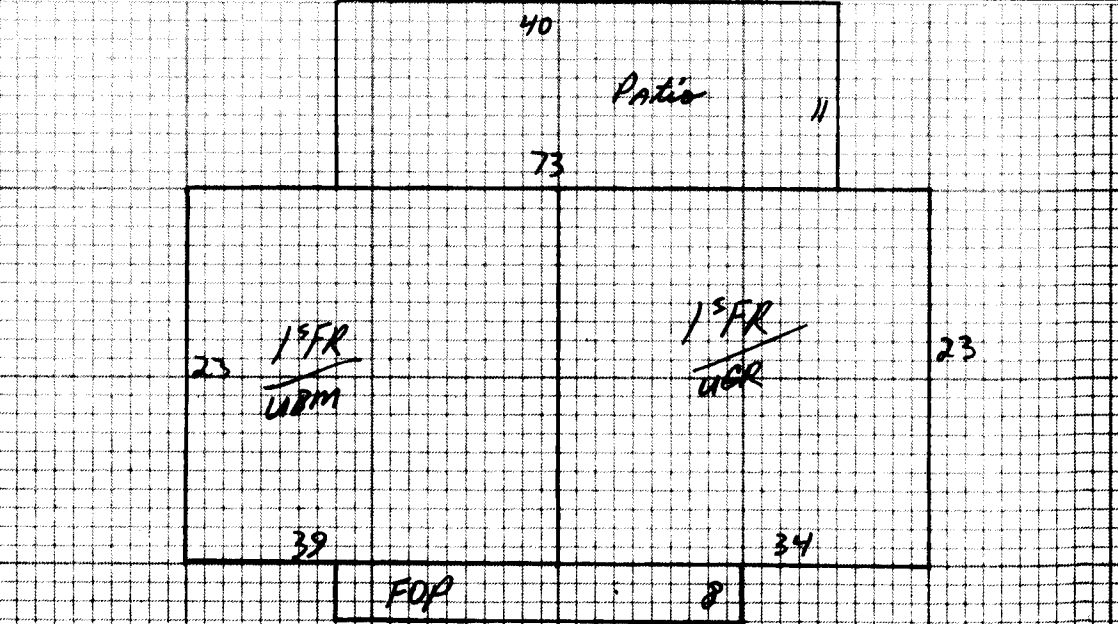

NOTES:

Dwelling <u>OW</u> ✓	Comp. Sh. ✓	Wood Siding ✓	Yr. Built <u>77</u> Remod.	Bermt. [] 2nd []	Plaster	BATH(S) / Full 1/2 Bath(s)
	Slats	Brick	No. Stories <u>1</u>	1st [x] 3rd []	Sheet rock	Modern Bath [] Modern Kitchen []
	Asbestos	Asb. Wood Shg.	S. Level [] S. Foyer []	Total No. Bedrooms <u>3</u>	Ceciled	Cent. Heat <u>Oil</u> A/C <u>NO</u>
	Metal	Cin. Block [] Stone []			Panel	Flr. or Wall Furnace [] Stove(s) []
Wood Frame ✓	Tar & Grav.	Stucco [] Con. Block []	Crawl [] Conc. []	HW [] Pine [] Carp. [] Tile []	Unfinished	
Cin. Block	Tile	Aluminum [x] Masonite []	Riers [] Cin. Blk. [x]			
Steel Frame	Shakes	Storm Doors [x] Storm Win. [] <u>NO</u>	Slab [] Brick []	Disappearing Stairs	Gd. [] Fair [] Poor [] VP []	Number <u>NO</u>

154R 1679 28 47012

Dwelling			<u>D-</u>	<u>48595</u>	<u>25%</u>	<u>36446</u>
Porch	<u>104</u>	<u>6</u>	<u>624</u>			<u>EV 400</u>
Carport						<u>FV 200</u>
Garage						
Cent. A/C						
Basement	<u>1679</u>	<u>65</u>	<u>10913</u>			

Concrete Pro 440
5+6 garage / woodshed
fractured

Basement Finish	M & L	M & L	Market Value All Improvements	<u>38400</u>
Attic	DATE	DATE	Market Value All Land	<u>4200</u>
Fireplace(s)	APRP.	APRP.	Size	<u>42600</u>
Heating	<u>M/S</u>		Not Home [] Time	
Bath(s)	DATE	DATE	Agric.	
Total	<u>58549</u>	<u>2-1-94</u>	Hort.	
Factor	<u>.83</u>	CLASSIFICATION	Forest	
Replacement	<u>48595</u>	ZONING	Open Space	
			Totals	

Home Site	Acres	Rate	Adj.	Home Site	Acres	Rate	Adj.
	<u>1</u>						
	<u>2</u>	<u>600</u>					

Home Site	Acres	Rate	Adj.	Home Site	Acres	Rate	Adj.
	<u>1</u>						
	<u>2</u>	<u>600</u>					
	<u>3</u>						
						<u>4200</u>	

General Remarks:

LEVEL [] SLOPES UP [] SLOPES DOWN []

LOW [] STEEP UP [] STEEP DOWN []

Land Cost	\$
Bldg. Cost	\$
Sale Price	\$
Rent	\$
Expenses	\$
Net Rent	\$

BOARD REVIEW NOTES