

CLASS	2	LEGAL DESCRIPTION	HONEY CAMP
ZONING		18A6	17.74 AC
DISTRICT	01		

BOGGS GORBET JR PAULINE RT 2 BOX 118H CLINTWOOD VA 24228	DATE RECORDED	
	DEED OR WILL BOOK	129-262
	CONSIDERATION	
	DATE RECORDED	
	DEED OR WILL BOOK	
	CONSIDERATION	
	DATE RECORDED	
	DEED OR WILL BOOK	
	CONSIDERATION	
	DATE RECORDED	
	DEED OR WILL BOOK	
	CONSIDERATION	
	DATE RECORDED	
	DEED OR WILL BOOK	
	CONSIDERATION	

1992			
1993			
1994	10,900	40,000	50,900
1995	10,900	40,000	50,900
1996			
1997			
1998	10,900	40,000	50,900
1999			
2000			
2001			
2002			
2003			

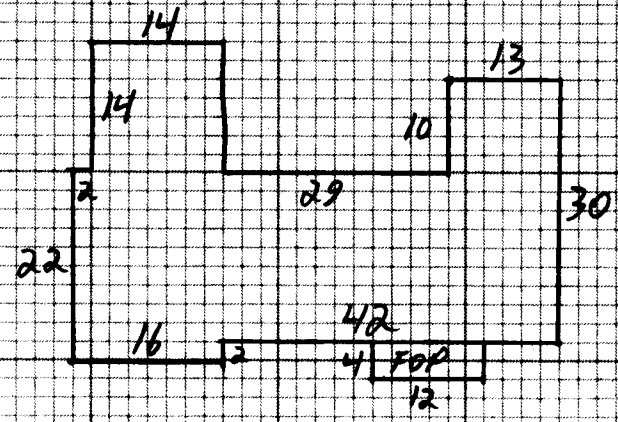

NOTES: 1.2556 AC TO DICKENSON COUNTY

Dwelling	<input checked="" type="checkbox"/>	Comp. Sh.		Wood Siding		Yr. Built <u>65</u>	Remod.		Bemt. [] 2nd []	Plaster		BATH(S) Full <input type="checkbox"/> 1/2 Bath(s)
		Slate		Brick	<input checked="" type="checkbox"/>	No. Stories			1st [] 3rd []	Sheet rock	<input checked="" type="checkbox"/>	Modern Bath <input type="checkbox"/> Modern Kitchen <input type="checkbox"/>
		Asbestos		Asb. Wood Shg.		S. Level <input type="checkbox"/> S. Foyer <input type="checkbox"/>			Total No. Bedrooms	Ceiled		Cent. Heat <input type="checkbox"/> A/C <input type="checkbox"/>
		Metal		Cin. Block <input type="checkbox"/> Stone <input type="checkbox"/>						Panel		Fir. or Wall Furnace <input type="checkbox"/> Stove(s) <input type="checkbox"/>
Wood Frame	<input checked="" type="checkbox"/>	Tar & Grav.		Stucco <input type="checkbox"/> Con. Block <input type="checkbox"/>		Crawl <input type="checkbox"/> Conc. <input type="checkbox"/>			HW <input type="checkbox"/> Pine <input type="checkbox"/> Carp. <input type="checkbox"/> Tile <input type="checkbox"/>	Unfinished	<input checked="" type="checkbox"/>	
Cin. Block		Tile		Aluminum <input type="checkbox"/> Masonite <input type="checkbox"/>		Flers <input type="checkbox"/> Cin. Blk. <input type="checkbox"/>						
Steel Frame		Shakes		Storm Doors <input type="checkbox"/> Storm Win. <input type="checkbox"/>		Slab <input type="checkbox"/> Brick <input type="checkbox"/>			Disappearing Stairs		Gd. <input type="checkbox"/> Fair <input type="checkbox"/> Poor <input type="checkbox"/> VP <input type="checkbox"/>	Number

15 BR 1518 30 45540

Basement Size ND Attic Floor & Stairs

Gd. Fair Poor VP Basement Finish Attic Walls Fl.

YR. 93 YR. YR.

Dwelling				<u>D</u>		<u>39619</u>		<u>20%</u>	<u>31700</u>
Porch								FV	<u>5000</u>
Porch								FV	<u>2000</u>
Carport				TRAILER Addition <u>14x24 336</u>		<u>10 3360</u>		<u>5%</u>	<u>7200</u>
Garage				<u>2 Deck 10x12 10x10 (220)</u>		<u>6 1320</u>		<u>5%</u>	<u>1300</u>
Cent. A/C									

Basement	M & L	M & L	Market Value All Improvements	<u>43200</u>	<u>-7 1/2%</u>
Basement Finish	DATE	DATE	Market Value All Land	<u>11,000</u>	<u>-10,800</u>
Attic	APRP <u>KSK</u>	APRP	Owner	<u>55,000</u>	<u>-50,800</u>
Fireplace(s)	DATE <u>2-28-93</u>	DATE	Make		
Heating	CLASSIFICATION <u>2</u>	ZONING	Size		
Bath(s)			Not Home <input type="checkbox"/> Time		
Total	<u>45540</u>		AM <input type="checkbox"/> PM <input type="checkbox"/>		
Factor	<u>.87</u>		Agric.		
Replacement	<u>39619</u>		Hort.		
			Forest		
			Open Space		
			Totals		

Public Water	Paved											Land Cost	
Public Sewer	Gravel											\$	
Well	<input checked="" type="checkbox"/> Dirt											Bldg. Cost	
Spring	No Road											\$	
Septic System	<input checked="" type="checkbox"/> Curb & Gutter											Sale Price	
U. G. Utilities	Sidewalk											\$	
												Rent	
												\$	
												Expenses	
												\$	
												Net Rent	
												\$	

General Remarks: Total DED. 7 1/2% DW

LEVEL SLOPES UP SLOPES DOWN

LOW STEEP UP STEEP DOWN

BOARD REVIEW NOTES