

*W. J. ...
...
...
24201*

CLASS	LEGAL DESCRIPTION
5	REEDY RIDGE
ZONING	36.22AC
DISTRICT	01

0011
HUGHES, BILLIE B 679-3805
P.O. Box 583
ST PAUL, VA 24283

DATE RECORDED	
DEED OR WILL BOOK	49-421
CONSIDERATION	YE- SE
DATE RECORDED	19-25
DEED OR WILL BOOK	248-519
CONSIDERATION	

DATE RECORDED	
DEED OR WILL BOOK	
CONSIDERATION	

DATE RECORDED	
DEED OR WILL BOOK	
CONSIDERATION	

DATE RECORDED	
DEED OR WILL BOOK	
CONSIDERATION	

1986	18 700	41500	60200
1987	18 700	41500	60200
1988	18 700	41500	60200
1989	18,700	41,500	60200
1990	18,700	41,500	60200
1991	18,700	37,000	55,700
1992			
1993			
1994			
1995			
1996			
1997			

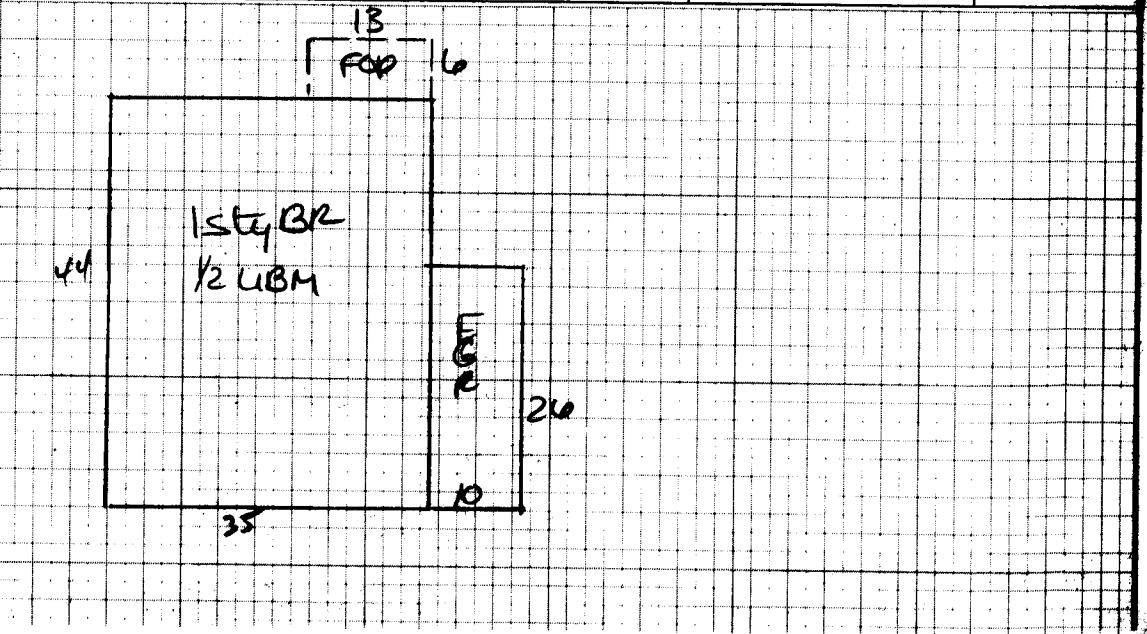

NOTES: 248-519 KATHIE HUGHES SELLS her INT @ 30,100
TO Billie B. Hughes.

Dwelling	Comp. Sh.	Wood Siding	Yr. Built <u>1960</u> Remod.	Bmnt. [] 2nd []	Plaster	BATH(S) / Full / 1/2 Bath(s)
	Shale	Brick	No. Stories <u>1</u>	1st <u>10</u> 3rd []	Sheet rock	Modern Bath <input type="checkbox"/> Modern Kitchen <input type="checkbox"/>
	Asbestos	Asb. Wood Shg.	S. Level <input type="checkbox"/> S. Foyer <input type="checkbox"/>	Total No. Bedrooms	Ceiling	Cent. Heat <u>Oil</u> A/C
	Metal	Cin. Block <input type="checkbox"/> Stone <input type="checkbox"/>			Panel	Fr. or Wall Furnace <input type="checkbox"/> Stove(s) <input type="checkbox"/>
Wood Frame	Tar & Grav.	Stucco <input type="checkbox"/> Con. Block <input type="checkbox"/>	Crawl <input type="checkbox"/> Conc. <input type="checkbox"/>	HW <input type="checkbox"/> Pine <input type="checkbox"/> Carp. <input type="checkbox"/> Tile <input type="checkbox"/>	Unfinished	
Cin. Block	Tile	Aluminum <input type="checkbox"/> Masonite <input type="checkbox"/>	Riers <input type="checkbox"/> Cin. Blk. <input type="checkbox"/>			
Steel Frame	Shakes	Storm Doors <input type="checkbox"/> Storm Win. <input type="checkbox"/>	Slab <input type="checkbox"/> Brick <input checked="" type="checkbox"/>	Disappearing Stairs	Col. <input type="checkbox"/> Pair <input type="checkbox"/> Poor <input type="checkbox"/> VP <input type="checkbox"/>	Number

1549 1540 315 48570

Porch <input type="checkbox"/>	<u>78</u>	<u>8</u>	<u>624</u>	Dwelling	<u>C-</u>	<u>53859</u>	<u>30%</u>	<u>35008</u>	YR. <u>86</u>	YR.	YR.
Porch				<u>BARN</u>							
Carport				<u>125M FR HOUSES</u>							
Garage	<u>2600</u>	<u>12</u>	<u>3120</u>	<u>2 REMOVED 1985</u>							
Cent. A/C				<u>2 STE ROOFS</u>							
Basement	<u>710</u>	<u>5</u>	<u>3850</u>								

Barnt. Finish	M & L	M & L	Market Value All Improvements	<u>46000</u>	<u>37000</u>
Attic	DATE	DATE	Market Value All Land	<u>18700</u>	<u>18700</u>
Fireplace(s)	APRP. <u>DD</u>	APRP.	Size	<u>60200</u>	<u>55700</u>
Heating	DATE <u>S-13-85</u>	DATE	Not Home <input checked="" type="checkbox"/> Time		
Bath(s)	CLASSIFICATION <u>S</u>	ZONING	AM <input checked="" type="checkbox"/> PM <input type="checkbox"/>		

Total	<u>56104</u>	Land Cost	
Factor	<u>.96</u>	Bldg. Cost	
Replacement	<u>53859</u>	Sale Price	
		Rent	
		Expenses	
		Net Rent	

CLASSIFICATION	ACRES	RATE	ADJ.	CLASSIFICATION	ACRES	RATE	ADJ.
Home Site	<u>2.</u>			Home Site			
	<u>5.</u>	<u>800</u>	<u>6000</u>				
	<u>29.22</u>	<u>300</u>	<u>4000</u>				
			<u>8700</u>				
Wasteland				Wasteland			
	<u>36.22</u>		<u>18700</u>				

General Remarks:

LEVEL SLOPES UP SLOPES DOWN

LOW STEEP UP STEEP DOWN

BOARD REVIEW NOTES