

HOLLINS, FREDDIE & KAREN
 RT 2 BOX 188
 CLINTWOOD, VA 24228

01239

DATE RECORDED 7-77
 DEED OR WILL BOOK 185-597
 CONSIDERATION ~~VE-~~ ~~SE~~ 100.00

DATE RECORDED
 DEED OR WILL BOOK
 CONSIDERATION

DATE RECORDED
 DEED OR WILL BOOK
 CONSIDERATION

DATE RECORDED
 DEED OR WILL BOOK
 CONSIDERATION

DATE RECORDED
 DEED OR WILL BOOK
 CONSIDERATION

BUILDING PERMITS

NOTES:

CLASS 2
 ZONING
 DISTRICT 01
 LEGAL DESCRIPTION
 GEORGES FORK
 .14AC ***

1986	3000	35,000	38,000
1987	3000	35,000	38,000
1988	3000	35,000	38,000
1989	3000	35,000	38,000
1990	3000	35,000	38,000
1991	3000	35,000	38,000
1992			
1993			
1994			
1995			
1996			
1997			

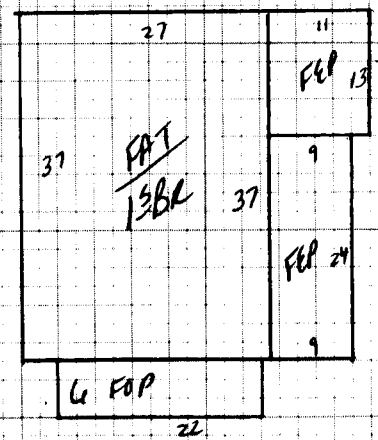

Dwelling	<input checked="" type="checkbox"/>	Comp. Sh.	<input checked="" type="checkbox"/>	Wood Siding		Yr. Built <u>52</u>	Remod. <u>79</u>	Bamt. [] 2nd []	Plester		BATH(S) / Full <input type="checkbox"/> 1/2 Bath(s) <input type="checkbox"/>		
		Slate		Brick	<input checked="" type="checkbox"/>	No. Stories		1st <u>6</u> 3rd []	Sheet rock		Modern Bath <input type="checkbox"/> Modern Kitchen <input type="checkbox"/>		
		Asbestos		Asb. Wood Shg.		S. Level <input type="checkbox"/> S. Foyer <input type="checkbox"/>		Total No. Bedrooms	Ceciled		Cent. Heat <u>oil</u> A/C <input type="checkbox"/>		
		Metal		Cin. Block <input type="checkbox"/> Stone <input type="checkbox"/>					Panel	<input checked="" type="checkbox"/>	Fir. or Wall Furnace <input type="checkbox"/> Stove(s) <input type="checkbox"/>		
Wood Frame	<input checked="" type="checkbox"/>	Tar & Grav.		Stucco <input type="checkbox"/> Con. Block <input type="checkbox"/>		Crawl <input type="checkbox"/> Conc. <input type="checkbox"/>		HW <input type="checkbox"/> Pine <input type="checkbox"/> Carp. <input checked="" type="checkbox"/> Tile <input type="checkbox"/>	Unfinished		Number <u>NO</u>		
Cin. Block		Tile		Aluminum <input type="checkbox"/> Masonite <input type="checkbox"/>		Riers <input type="checkbox"/> Cin. Blk. <input type="checkbox"/>					Number Chimneys		
Steel Frame		Shakes		Storm Doors <input type="checkbox"/> Storm Win. <input type="checkbox"/>		Slab <input type="checkbox"/> Brick <input checked="" type="checkbox"/>		Disappearing Stairs		Gd. <input type="checkbox"/> Fair <input type="checkbox"/> Poor <input type="checkbox"/> VP <input type="checkbox"/>	Brick [] C. Block []		
						Basement Size <u>NO</u>		Attic Floor & Stairs			Stone [] Metal []		
						Gd. <input checked="" type="checkbox"/> Fair <input type="checkbox"/> Poor <input type="checkbox"/> VP <input type="checkbox"/>	Basmt. Finish	1/4 <input type="checkbox"/> 1/2 <input type="checkbox"/> 3/4 <input type="checkbox"/> Full <input type="checkbox"/>	Attic <input type="checkbox"/> Walls <input type="checkbox"/> Fl. <input type="checkbox"/>		YR. <u>86</u>	YR.	YR.

13BL 999 33 32,967

Dwelling						<u>DA</u>	<u>43,750</u>	<u>-20%</u>	<u>35,000</u>		
Porch	<u>E</u>	<u>359</u>	<u>14</u>	<u>5026</u>							
Porch	<u>D</u>	<u>132</u>	<u>10</u>	<u>1320</u>							
Carport											
Garage											
Cent. A/C											
Basement											

M & L	M & L	MOBILE HOME INFORMATION	Market Value All Improvements	<u>35,000</u>
DATE	DATE	Owner	Market Value All Land	<u>3,000</u>
APRP	APRP	Make	Year	<u>38,500</u>
DATE	DATE	Size	Cond.	
<u>3-26-85</u>		Not Home <input type="checkbox"/> Time		
CLASSIFICATION	ZONING	AM <input checked="" type="checkbox"/> PM <input type="checkbox"/>		
<u>2</u>		<u>OWNED</u>		

Total 47,554
 Factor .92
 Replacement 43,750

Agric.		Land Cost	
Hort.		\$	
Forest		Bldg. Cost	
Open Space		\$	
Totals		Sale Price	
		\$	
		Rent	
		\$	
		Expenses	
		\$	
		Net Rent	
		\$	

PROPERTY FACTORS				CLASSIFICATION				CLASSIFICATION			
Public Water	Paved	Public Sewer	Gravel	Home Site	ACRES	RATE	ADJ.	Home Site	ACRES	RATE	ADJ.
	<input checked="" type="checkbox"/>		<input checked="" type="checkbox"/>		<u>.14</u>					<u>3000</u>	
Well	<input checked="" type="checkbox"/> Dirt	Spring	<input checked="" type="checkbox"/> No Road	Wasteland				Wasteland			
Septic System	<input checked="" type="checkbox"/> Curb & Gutter	U. G. Utilities	<input checked="" type="checkbox"/> Sidewalk		<u>.14</u>					<u>3000</u>	

General Remarks: BELOW RD

LEVEL SLOPES UP SLOPES DOWN
 LOW STEEP UP STEEP DOWN

BOARD REVIEW NOTES